

Key

- Primary Route
- Secondary Route
- Nature Route
- Board Walk
- Contours
- Existing Vegetation
- Proposed Tree Planting
- Short Mown Grass
- Ponds
- Orchard
- Reed Beds with small pockets of open water
- Scrapes
- Enhanced Proposed and Existing Car parks
- Wet Meadow
- Species rich grassland
- Scattered Scrub/ Mosaic Habitat
- 'Beach' Zone
- FP Fishing Peg
- PA Picnic Area Tables
- Principal Access Points / Entrances
- Play Sculpture/ Sculptural Feature
- Other Feature

Notes

- 1 Existing undulations and desire line to be left undisturbed
- 2 Sections of river bank to be graded back to shallower angle to allow for establishment of reeds and other marginals
- 3 Car Park extensions consist of cellular permeable paving system filled with gravel. (Number of spaces shown in brackets)
- 4 Alternative Bike Route for younger children with low humps and other small obstacles
- 5 Existing ponds to be dredged to enlarge/reinstate areas of standing water
- 6 Close mown circles intended to provide 'picnic islands' among longer sward located either side of existing desire line (which is also regularly mown)
- 7 4-5m High viewing mound (utilising excavated material from reed bed areas) constructed adjacent to proposed 'Street Skate' area
- 8 Boardwalk through area of Osiers (some of which will be used to create willow dens/other play sculptures)
- 9 Future proposed access to Leisure Centre Car Park
- 10 Rejuvenated river frontage to include 'beach', pontoon for canoists and jetty for river taxi and accessible fishing pegs
- 11 'Wildwood and Wild Willow Trail' aimed at younger children to include play sculptures, steps, mini rivers and den building
- 12 Principal entrance points to include site information/map with further signage and wayfinding markers installed throughout site
- 13 Riverside Park 'Sentinel' sign / associated map to divert arrivals at multi-story car park/leisure centre visitors into the green corridor
- 14 Cycleway/footpath. Link to Riverside Caravan Park, to be constructed as part of future phase.
- 15 Additional trees to be planted in existing Leisure Centre car park. In order to improve amenity and provide shade during summer months
- 16 Existing bin store/waste disposal point to be converted to informal play feature/'Lookout'
- 17 New native hedge to screen carpark
- 18 Bridgefoot Park main footpath/ cycleway route to be widened to 3m and additional planting (in riverside theme to be added).
- 19 Habitat Improvements to Swannery
- 20 Existing bridge to be replaced by single span hardwood timber bridge
- 21 Existing timber bridge to be replaced by new 3m hardwood bridge

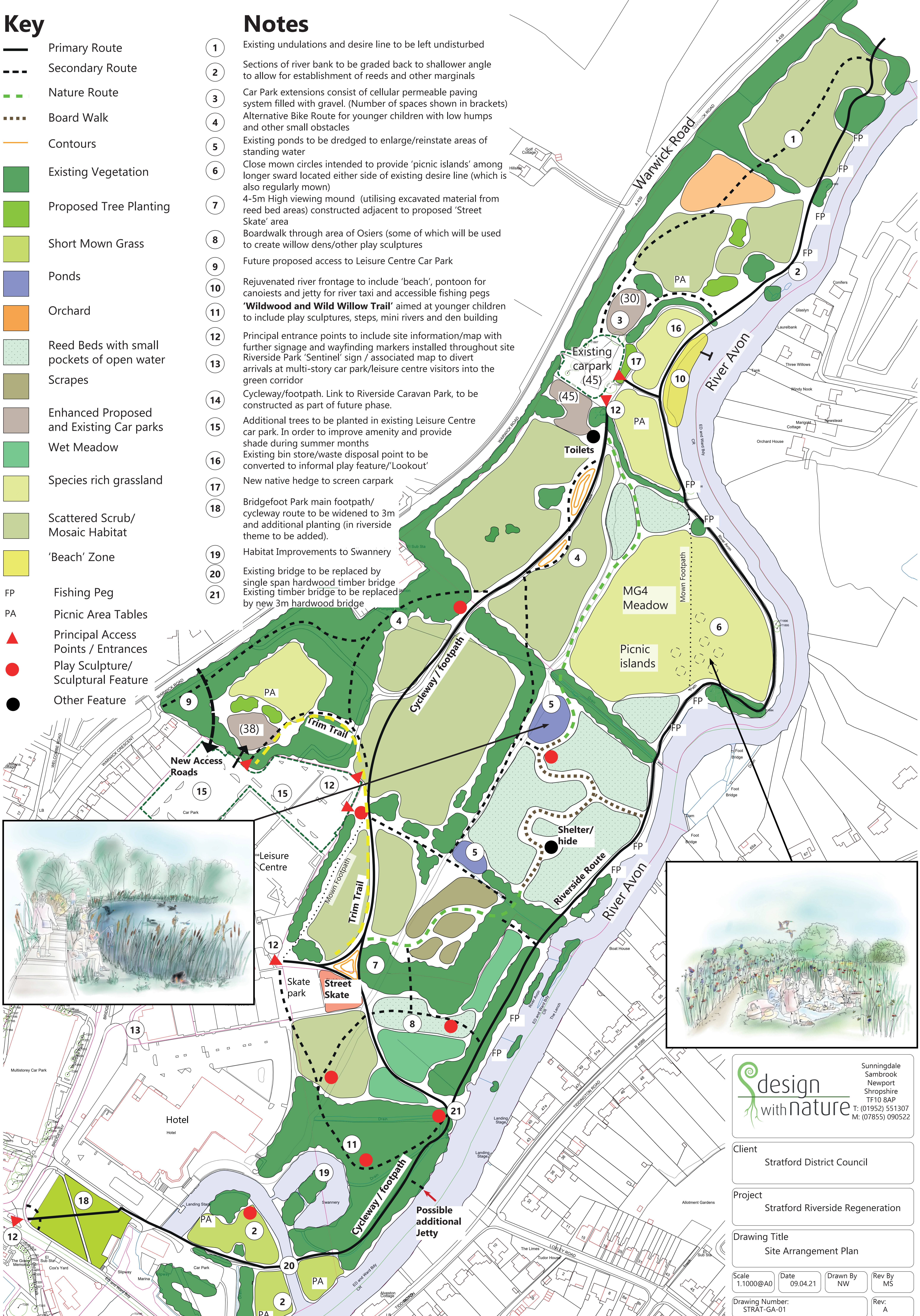

design with nature
 Sunningdale
 Sambrook
 Newport
 Shropshire
 TF10 8AP
 T: (01952) 551307
 M: (07855) 090522

Client
 Stratford District Council

Project
 Stratford Riverside Regeneration

Drawing Title
 Site Arrangement Plan

Scale 1:1000@A0 Date 09.04.21 Drawn By NW Rev By MS

Drawing Number: STRAT-GA-01 Rev: A