



Permeable paving filled with gravel (indicative image)



Native enriched turf (proposed for top of gabion walls) (indicative image)



### 1:500 Plan: Fishermans Car Park Extensions and River Frontage

#### Notes

Fishermans car park extension works to create an additional 71 spaces in addition to 48 existing.

- 1m High gabion wall faced with local stone and topped with wildflower turf.
- Existing height restriction barrier replaced with bespoke arch and set back 6m from highway.
- Hardwood jetty or floating pontoon parallel to river. See section JJ on drawing no. STRAT-LP-05.
- Existing concrete removed and sloping gravel bank installed (Max 1 in 4 gradient).
- Additional accessible fishing peg.
- Orientation space with timber clad toilet building (2 Male, 2 Female and 1 accessible), space for mobile catering van, information board, hardwood seating and laying of new hardstanding.
- Hardwood picnic tables.
- Existing concrete pad extended and utilised to accommodate wheelchair accessible picnic table.
- 1.5m Wide 500mm 'roll-over' mound created (using excavated material) in order to prevent vehicle access onto the site.
- Gap left to facilitate views of the river from adjacent designated blue badge spaces.
- Existing tarmac to be replaced with permeable paving infilled with blocks in order to visually signify main cycleway/ footpath route entrance; Hardwood bollards to be installed around the perimeter in order to prohibit vehicular access.
- Permeable paving with blocks installed to create larger entrance to riverside footpath route.
- Existing hedgerow to be trimmed back as required to accommodate parking bays.

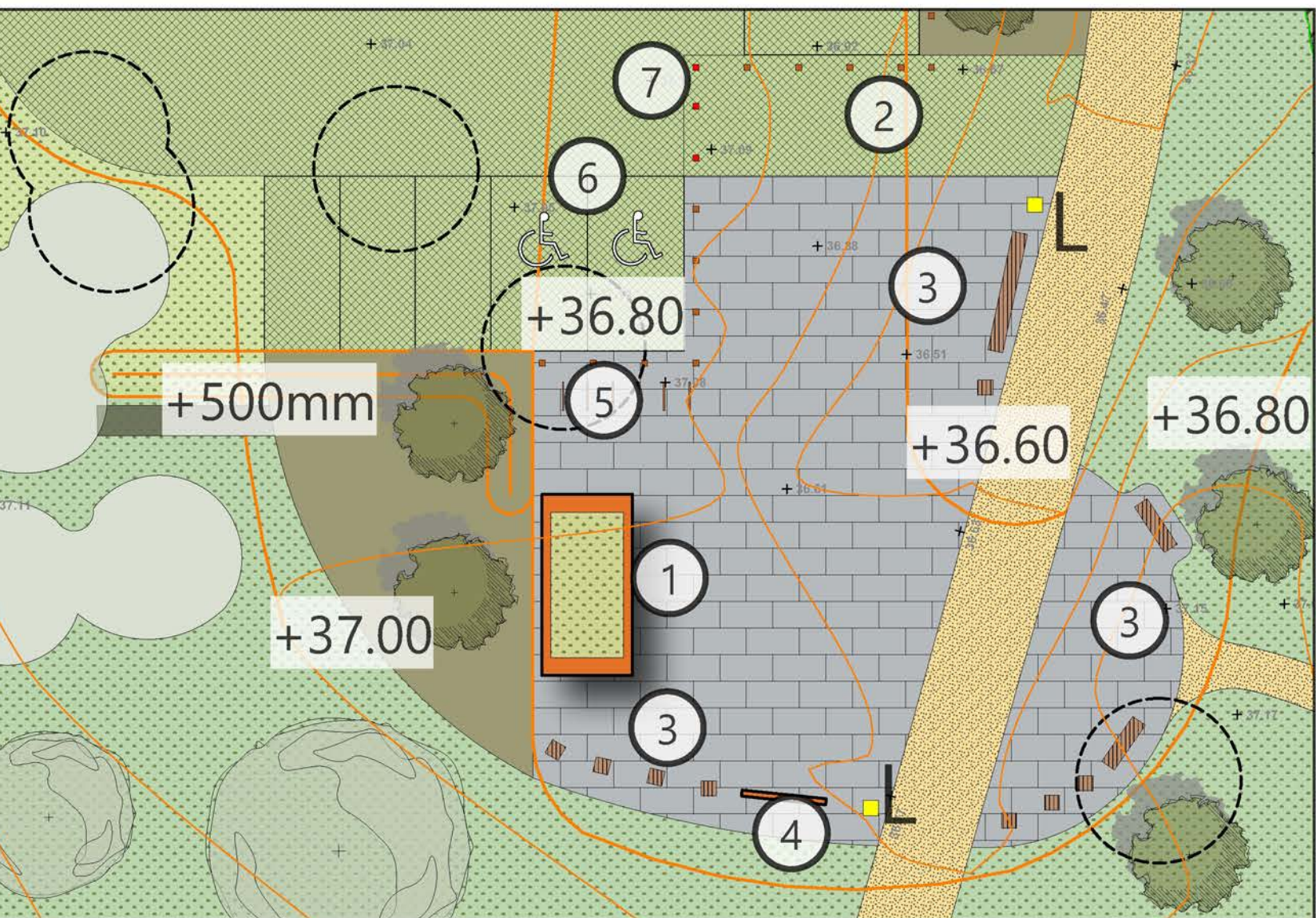

### 1:200 Plan: Proposed orientation space and toilets

#### Notes

- Proposed toilet building with green roof - See drawing number Strat-LP-05.
- Parking space for mobile catering van.
- Hardwood cubes, seat and 4m long bench.
- Information board / site map.
- Cycle stands and floor mounted pump.
- Disabled parking spaces.
- Dropable bollard to facilitate access for mobile catering van.

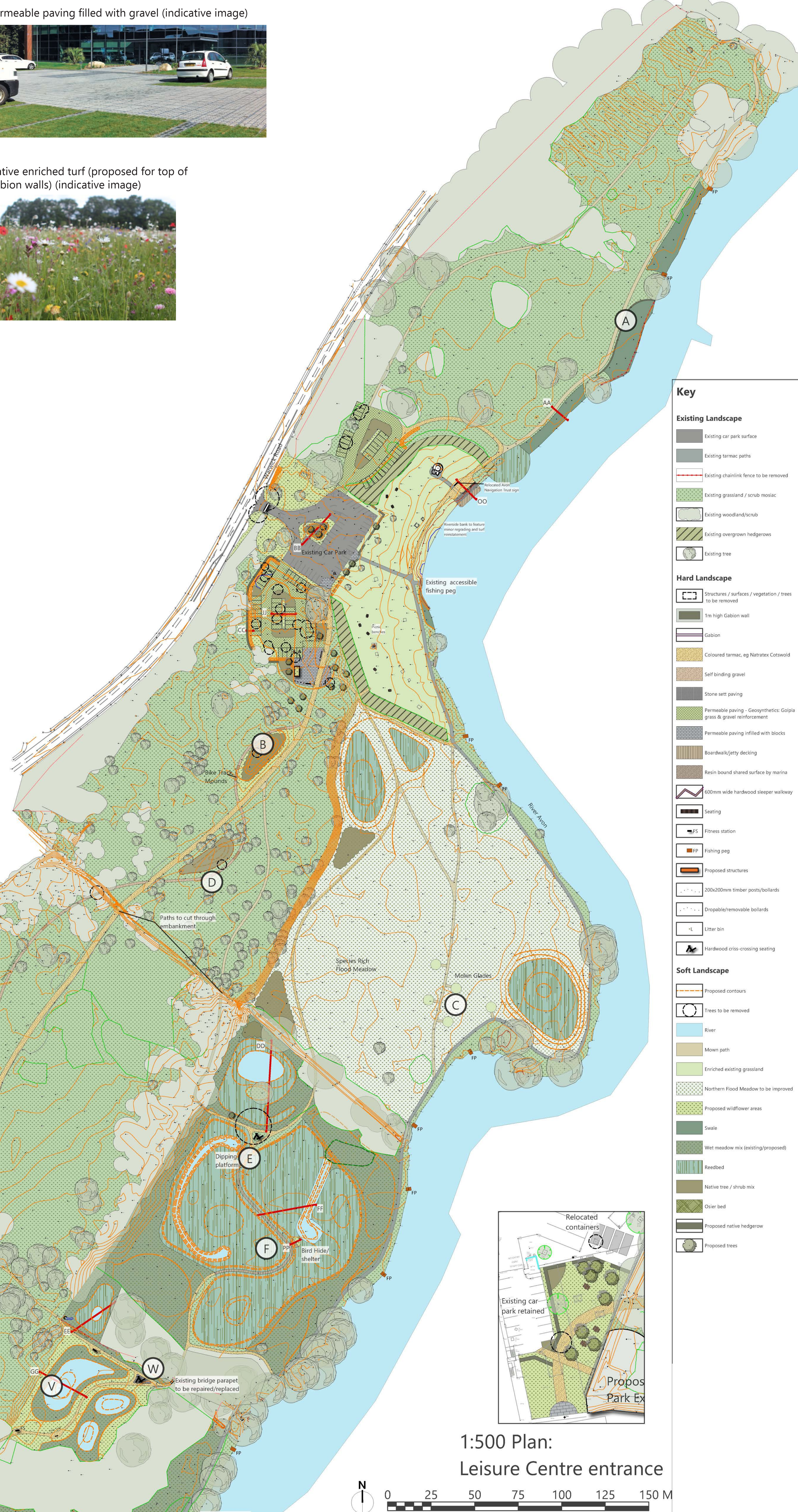

### 1:500 Plan: Leisure Centre entrance



#### Notes

- Sections of river bank to be regraded to a nominal gradient of 1 in 6; existing chainlink fence to be replaced.
- Native shrubs planted on low mounds.
- Circles of short mown grass (with connecting pathways) for informal picnics.
- Alternative route (aimed at children) incorporating low humps/other obstacles.
- Hardwood dipping platform.
- Informal open sided bird hide, with screen and projecting green roof canopy.
- Principal arrival/orientation space for Leisure Centre car park users.
- Sculptural earthworks designed as informal play feature/venue for informal picnics.
- 3no. Electric vehicle charging points.
- Sundial sculpture installed at top of mound.
- Rope suspension bridge/hardwood beams crossing points across existing ditch.
- Existing bridge to be replaced with 3m wide timber bridge.
- Selective thinning to be carried out in this area to increase light levels/improve structure of plantation woodland; woodland wildflowers are to be introduced and marginals established on the banks of the Swannery.
- Existing concrete bridge to be replaced with 18m long 3.5m wide timber clad steel single span bridge.
- Wildwood and Willow Trail aimed at younger children including natural willow structures sculptures/den building areas, and obstacles.
- Embankments supporting ramped footpath to be sown with wildflowers.
- Existing road surface to be lifted and shared surface paving installed, to improve safety for vehicles and pedestrians.
- Existing footpath to widened to 3m and yew resurfaced and hedges installed, to improve sense of enclosure.
- Hardwood sleeper walkway.
- 3m wide boardwalk across existing wetland (with 1.4m high parapet either side).
- Existing ruderal vegetation cleared; steel rail removed and area sown with wildflower grass mix.
- Ponds/swales to have mix of reeds and open water areas (various depths).
- Existing bridge - parapet to be made good as required.
- Additional trees to be planted in leisure centre carpark to provide shade and intercept surface water.

#### Key

##### Existing Landscape

- Existing car park surface
- Existing tarmac paths
- Existing chainlink fence to be removed
- Existing grassland / scrub mosaic
- Existing woodland/scrub
- Existing overgrown hedgerows
- Existing tree

##### Hard Landscape

- 1m High Gabion wall
- Gabion
- Coloured tarmac, eg Natratex Cotswold
- Self binding gravel
- Stone sett paving
- Permeable paving - Geosynthetic: Geopla grass & gravel reinforcement
- Permeable paving infilled with blocks
- Boardwalk/jetty decking
- Rain bound shared surface by marina
- 600mm wide hardwood sleeper walkway
- Seating
- Fitness station
- Fishing peg
- Proposed structures
- 200x200mm timber posts/bollards
- Dropable/removable bollards
- Litter bin
- Hardwood cross-crossing seating

##### Soft Landscape

- Proposed contours
- Trees to be removed
- River
- Mown path
- Enriched existing grassland
- Northern Flood Meadow to be improved
- Proposed wildflower areas
- Seale
- Wet meadow mix (existing/proposed)
- Reedbed
- Native tree / shrub mix
- Osier bed
- Proposed native hedgerow
- Proposed trees